



## Installation Instructions

### 81090

#### **MAGNUM GRIP SHIFTER HANDLE** **2005-15 TOYOTA TACOMA, 2009-20** **TUNDRA, 2008-20 SEQUOIA &** **2010-20 4RUNNER**

All models and engines with automatic transmission.



Watch our  
installation video  
on YouTube

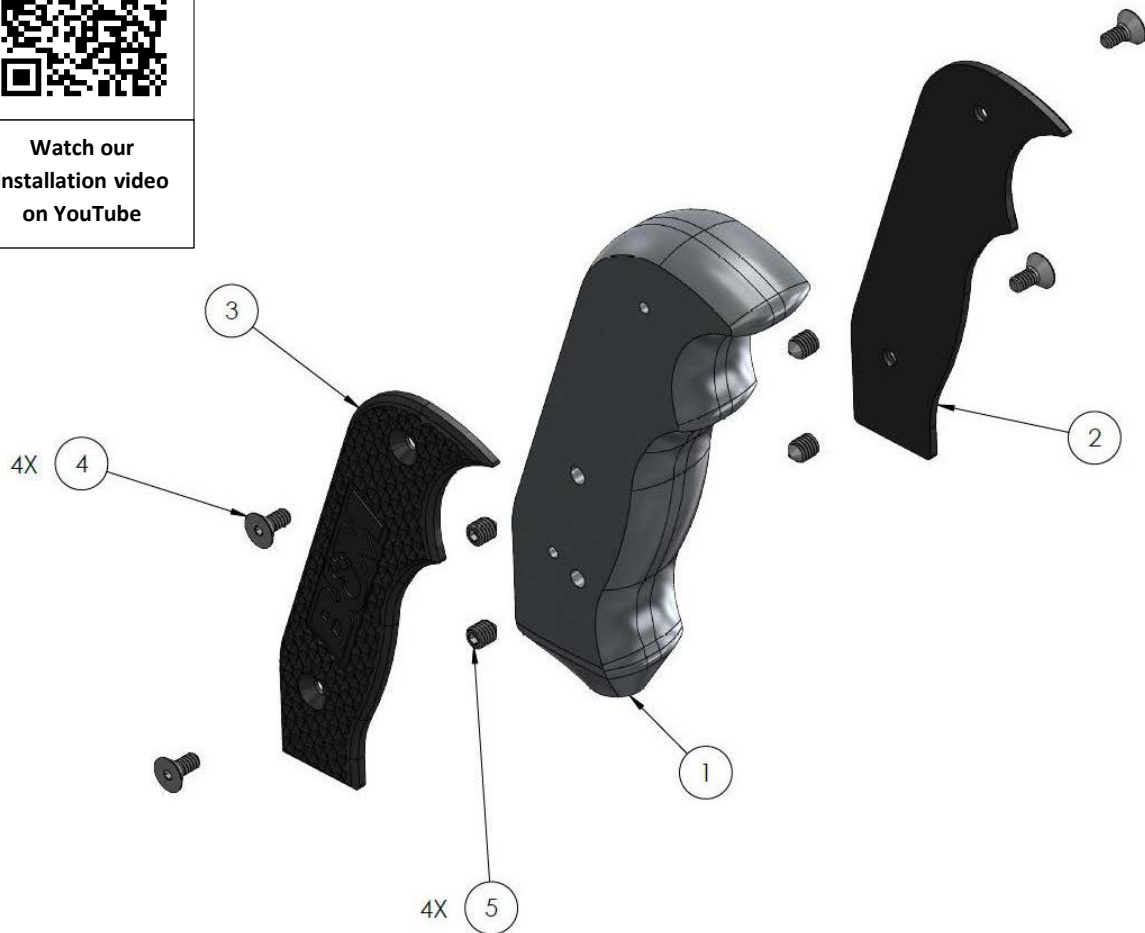

ITEM NO.	PART NO.	DESCRIPTION	QTY.
1	4001720-88	MAGNUM GRIP SHIFTER HANDLE BODY	1
2	4001492-88	MAGNUM GRIP SHIFTER PLATE, LEFT, DIAMOND KNURL, BLACK	1
3	4001495-88	MAGNUM GRIP SHIFTER PLATE, RIGHT, DIAMOND KNURL, BLACK	1
4	3401537	SCREW, SOCKET, FLAT HEAD, 6-32 × 5/16", STAINLESS	4
5	3401543	SET SCREW, CONE POINT, 10-32 × 1/4", 18-8 SS	4

**Before starting**, take a moment to read and understand these instructions before installing your B&M Magnum Grip Shifter Handle. Use the parts drawing and list (front page) to verify your kit's contents. In the unlikely event of missing parts, please contact B&M Technical Support for replacements.

**We highly recommend that you retain all factory parts.**



1. **Turn off your vehicle's ignition and set the parking brake.** Remove the stock shifter handle by rotating it counter-clockwise on the shifter stick.



4. Properly align the shift handle by backing it up slightly, then tighten all four set screws.



2. Thread the 4 set screws (Item 5) into the shifter handle body (1) until they are almost flush with the handle body. (Two screws each side.)



5. Install the left and right side plates (2) and (3) with the 4 flathead screws (4). (Two screws each side.)



3. Thread the handle body all the way on to the shifter stick.



**Congratulations, the installation of your B&M Magnum Grip Shifter Handle is now complete!**